

TANGENT	BEARING	LENGTH
T1	S64°10'44"W	215.50'
T2	S82°33'31"W	275.60'
T3	S82°33'31"W	36.80'
T4	S86°44'39"W	297.85'
T5	N88°14'02"W	97.36'
T6	N80°56'08"W	100.59'
T7	N87°30'00"W	56.26'
T8	N87°30'00"W	46.25'
T9	S87°36'38"W	100.81'
T10	N87°35'55"W	376.50'

TANGENT	BEARING	LENGTH
T11	S76°24'39"W	417.42'
T12	S08°40'21"E	209.48'
T13	S75°00'14"W	220.31'
T14	N76°54'03"W	134.63'
T15	N58°49'24"W	203.04'
T16	N85°56'31"W	125.91'
T17	N16°13'33"E	322.94'
T18	N04°43'15"E	141.12'
T19	N04°43'15"E	169.51'
T20	N03°32'23"E	395.50'

NOTE: THERE MAY BE ADDITIONAL EASEMENTS OR ENCUMBRANCES AFFECTING THIS TRACT THAT ARE NOT SHOWN HEREON.

NOTE: ALL BEARINGS & DISTANCES ARE CALL & ACTUAL UNLESS NOTED.

SCALE: 1" = 400'  
 COUNTY: ANDERSON  
 ACREAGE: 55.17 AC.

○ = 1/2" SIR UNLESS NOTED

NOTE: VOL. 581, PG. 384 AFFECTS THIS TRACT, HOWEVER, THERE IS NO EVIDENCE ON THE GROUND

SURVEY: SEE PLAT  
 DESCRIPTION: VOL. 2262, PG. 105  
 SURVEYED FOR: SECURE COVENANT

I, Mark Ferrell, Registered Professional Land Surveyor 4373, do hereby certify that the above survey plat and notes of even date represent the results of an on the ground survey made under my direction and supervision. Surveyed this 30th Day of JULY, 2011.

**HEARN SURVEYING ASSOCIATES**

201 HWY. 175 W, SUITE 2  
 ATHENS, TX 75751  
 (903) 675-2858

1-800-432-7670

REVISED 09/22/11

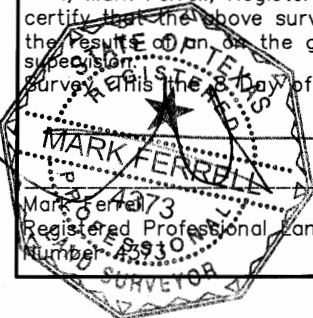

USE OR REPRODUCTION OF THIS SURVEY FOR ANY PURPOSE BY OTHER PARTIES IS PROHIBITED. SURVEYOR IS NOT RESPONSIBLE FOR ANY LOSS RESULTING THEREFROM.